

5/2 Way Poppet Type UTI - Sugar Valve

Features

- ▶▶ Poppet type Heavy duty Valve
- ▶▶ Suitable for Loading & Unloading Application
- ▶▶ High Flow Volume
- ▶▶ Fast Action
- ▶▶ Coil - Continuous duty low power consumption, CIMFR & CE Approved.
- ▶▶ Superior High Grade Seals
- ▶▶ Simple design easy to maintenance
- ▶▶ Manual Operator Push, Rotate & Lockable type.

Technical Specification

| | |
|---------------|---|
| Model | UTI - SUGAR - 502 |
| Size | 1/4" |
| Design | Poppet type, |
| Pressure | 2.5 to 10 Kg/cm ² |
| Temperature | 80 °C |
| Leakage | Bubble Tight |
| Duty Cycle | Continuous Rated |
| Protection | IP 65 [Flameproof / Explosion Proof As Per IS / IEC 60079 - 1 Standard Approved by Central Institute of Mining and Fuel Research (CIMFR)] |
| Connector | DIN 43650 A |
| Response Time | 15 msec ON / 25 msec OFF |
| Coil Voltage | 12V, 24V, 48V, 110V, 230V, (AC / DC) 50 / 60 Hz (Non Std. Voltage Available On Request) |
| Media | Compressed Air (Filtered & Lubricated) |
| Weight (Kg) | 0.800 |

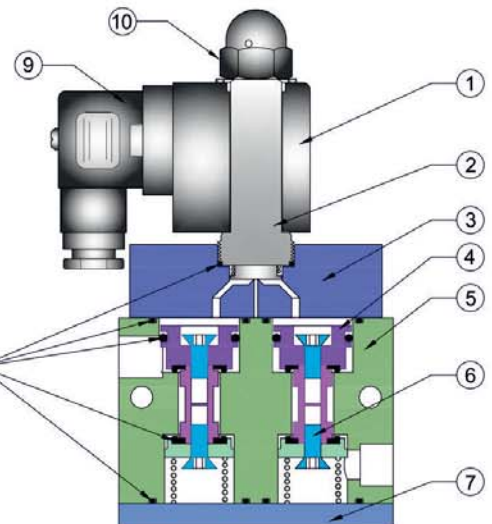

| No. | Part Name | Material |
|-----|-------------------|-------------------|
| 1 | Coil | Std. Material |
| 2 | Armature Assembly | Standard Steel |
| 3 | Armature Top | Aluminium |
| 4 | Piston Assembly | Aluminium / Brass |
| 5 | Body | Aluminium |
| 6 | Allen Key Screw | S. Steel |
| 7 | Base Plate | Aluminium |
| 8 | 'O' Ring / Gasket | NBR |
| 9 | Din Connector | Din 43650A |
| 10 | Cap Nut | Steel Plated |

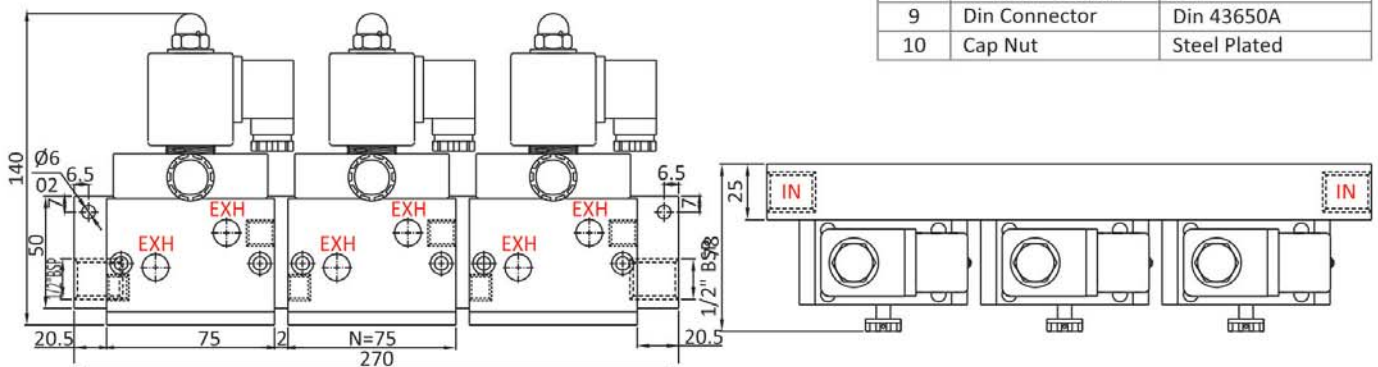
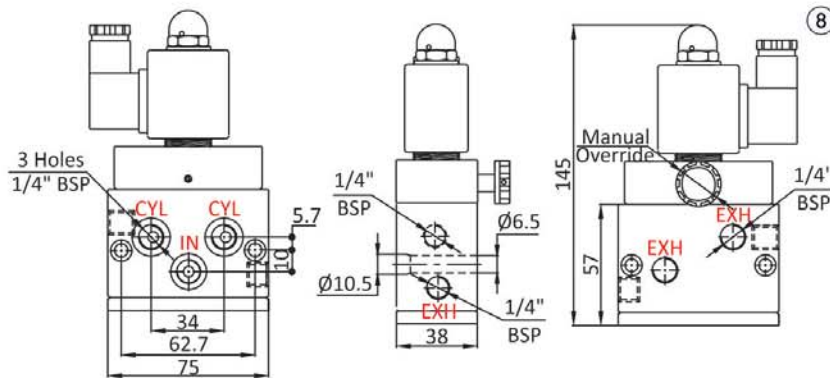

Note : Since, constant worldwide advancement in technology, We keep our rights reserved to make changes time to time in Technical Specification and Dimensions without prior notice.